

Can also be delivered with:

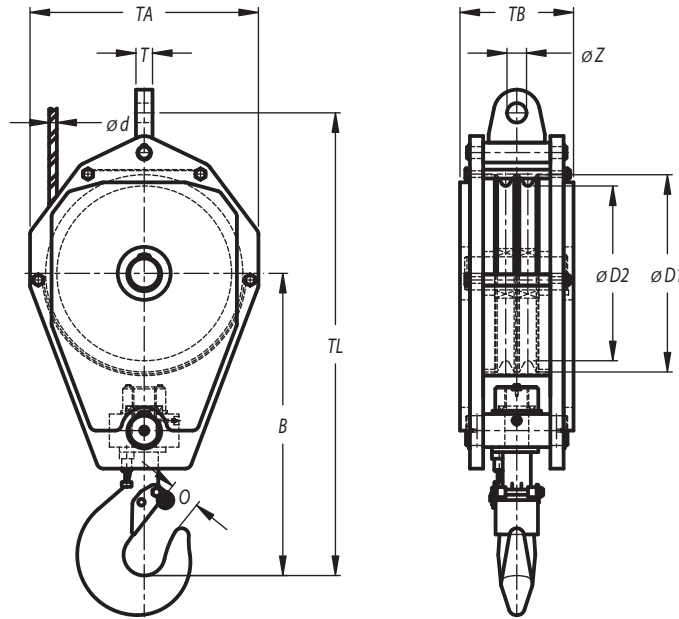

Stock No.	Model No.	WLL (t)	Wire (mm)	Dimensions (mm)									Weight (kg)
				ØD1	ØD2	B	O	TA	TB	TL	T	ØZ	
22.300.016.21	SRB 260.2.16	16	11-12	300	260	575	59	400	165	860	28	32	130
22.320.016.21	SRB 285.2.16	16	15-16	320	285	585	59	400	165	885	28	32	130
22.320.020.21-1	SRB 285.2.20	20	15-16	320	285	660	69	400	165	960	28	32	130
22.320.020.21-2	SRB 285.2.20	20	17-19	320	285	660	69	400	165	960	28	32	150
22.365.020.21	SRB 320.2.20	20	15-16	365	320	690	69	450	180	1115	28	32	160
22.410.029.21	SRB 355.2.29	29	17-19	410	355	760	69	500	250	1100	35	37	250
22.460.020.21	SRB 400.2.20	20	24-26	460	400	825	69	570	180	1180	45	52	180
22.460.025.21	SRB 400.2.25	25	24-26	460	400	825	69	570	180	1205	45	52	200
22.460.029.21	SRB 400.2.29	29	20-22	460	400	750	69	570	240	1130	40	43	320
22.515.030.21	SRB 450.2.30	30	24-26	515	450	850	69	605	220	1275	45	52	300
22.515.050.21	SRB 450.2.50	50	24-26	515	450	850	84	605	325	1275	45	52	550
22.595.063.21	SRB 520.2.63	63	27-28	596	528	1085	97	710	405	1565	50	59	980
22.595.080.21	SRB 520.2.80	80	27-28	596	528	1150	110	710	440	1610	50	59	1000

Minimum Ultimate Strength = 4 x WLL.

- Standard fitted with cylindrical roller bearing, reeving guide and becket.
- Standard painted in yellow with black stripes.
- Sheaves of reeve blocks can be adjusted to other wire rope diameters.
- Third party testing with certification available upon request.
- Standard fitted with hook according DIN 15401