

Can also be delivered with:

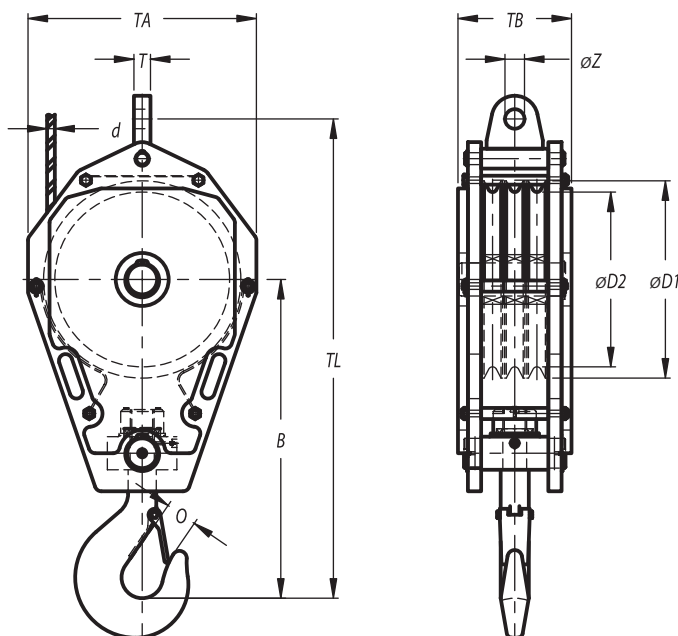

Stock No.	Model No.	WLL (t)	Wire d (mm)	Dimensions (mm)									Weight (kg)
				ØD1	ØD2	B	O	TA	TB	TL	T	ØZ	
23.280.016.31	FRB 250.3.16	16	11-12	280	250	700	59	360	220	975	22	27	200
23.320.020.31	FRB 285.3.20	20	13-14	320	285	770	69	400	220	1075	28	32	230
23.365.025.31	FRB 320.3.25	25	15-16	365	320	780	69	450	220	1100	28	32	290
23.410.032.31	FRB 355.3.32	32	17-18	410	355	860	76	500	240	1200	35	37	350
23.460.040.31	FRB 400.3.40	40	19-20	460	400	950	84	550	310	1325	40	43	500
23.515.050.31	FRB 450.3.50	50	21-22	515	450	1000	97	600	335	1400	40	43	650
23.595.063.31	FRB 520.3.63	63	24-26	595	520	1050	97	680	335	1500	45	52	900
23.650.080.31	FRB 570.3.80	80	28-29	650	570	1350	110	750	370	1825	50	59	1300
23.720.100.31	FRB 630.3.100	100	30-32	720	630	1550	132	850	370	2075	60	65	1600

Minimum Ultimate Strength = 4 x WLL.

- Standard fitted with cylindrical roller bearing, reeving guide and becket.
- Standard painted in yellow with black stripes.
- Standard sheaves of reeve blocks can be adjusted to other wire rope diameters.
- Third party testing with certification available upon request.
- Standard fitted with hook according to DIN 15401